

# ORCA™ MODEL OG15



## MODEL OG15 SPECIFICATIONS

<b>REQUIRED SUPPLIES</b> ORCA Biochips, microorganisms & wipers	<b>DIMENSIONS</b> L 31.89" x W 26.77" x H 45.52" (L 81 cm x W 58 cm x H 108 cm)
<b>WEIGHT</b> 350 lbs (159 kg)	<b>HOURLY PROCESSING CAPACITY</b> Average of 15 lbs (7 kg) per hour
<b>ELECTRICAL CONSUMPTION</b> 0.43 kWh	<b>WATER CONSUMPTION</b> 114 gallons (430 liters) per day* *Calculated based on an incoming flow rate of 2 gallons (7.6 liters) per minute*
<b>INSTALLATION REQUIREMENTS</b> Electrical - Dedicated 120 V / 220 V Electrical Cord Length - 36 - 48 inches (91 - 121 cm) Water - Cold 1/2 inch (1.3 cm) water connection Drain - 2 inch (5.08 cm) drain complete with grease interceptor Additional Space - A minimum of 24 inches (62 cm) of free space must be available on both sides of the machine	

## FEATURES

- Aerobically processes an average of 15 lbs (7 kg) of food waste per hour
- On-board scales for diversion tracking, with an extractable data file through ethernet or USB
- Online customer portal for diversion goal tracking and reporting
- Food-grade stainless steel construction
- Safety control turns off the machine when door is opened
- Food waste can be added continually within the unit's designated capacity limits
- Engineered for quiet operation, with a touch screen HMI
- Utilizes ORCA Biochips to hold high levels of microorganisms that digest organic waste
- Effluent from machine tested safe to enter the wastewater system



# ORCA™ MODEL OG15

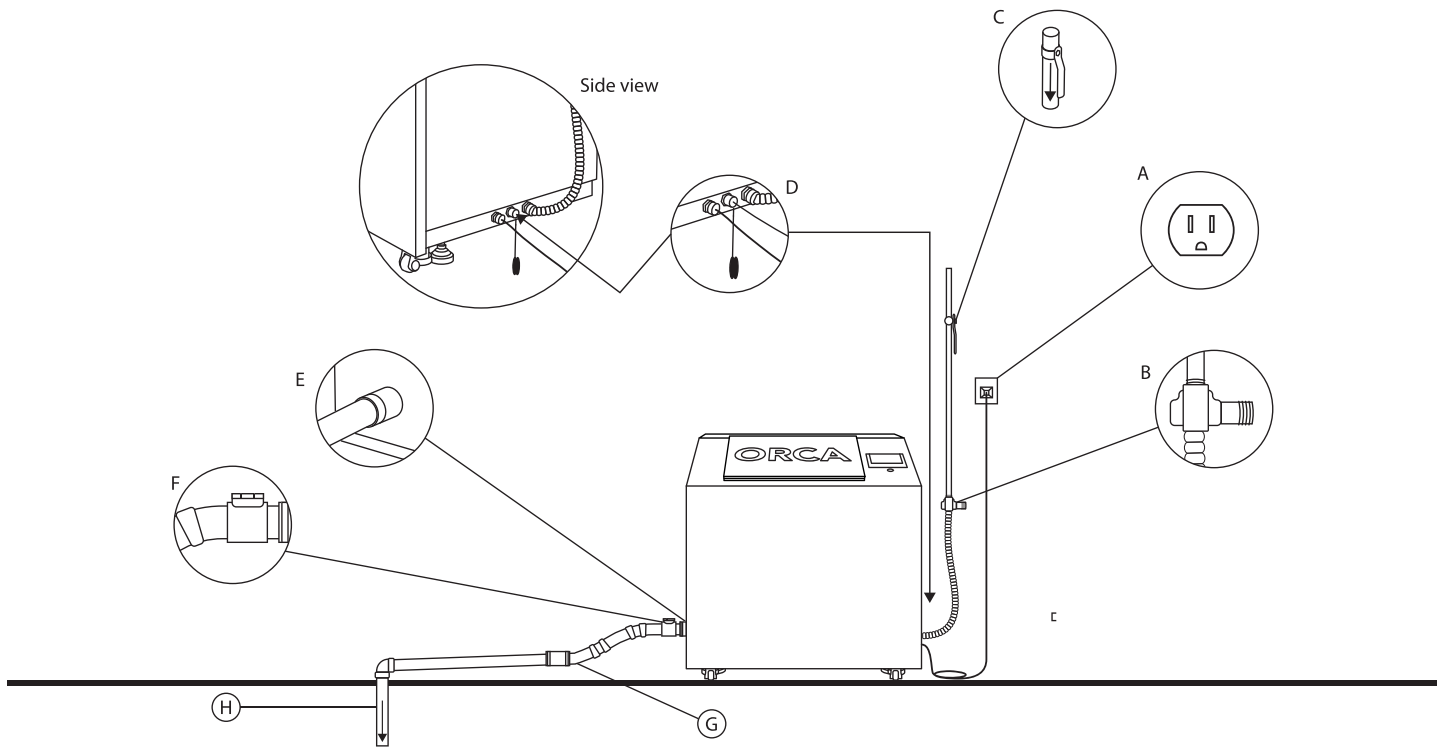

- A - Dedicated 120 V or 220 V outlet on a dedicated breaker
- B - 1/2 inch (1.3 cm) cold waterline connected to the provided flex line via a garden hose fitting
- C - Water shutoff valve connected to the cold-water line upstream from the ORCA
- D - WIFI or ethernet connection
- E - Drain line that is compatible with the ORCA's 2" (5.08 cm) exit pipe
- F - Plumbing cleanout approximately 5" (13 cm) from the ORCA
- G - Direct drain line with a slope of 1/2" per 12" (1.3 cm per 30 cm) downstream of the ORCA  
\*Avoid the use of P-traps\*
- H - Downstream above or below-ground grease interceptor
- I - 24" (62 cm) of free space on both sides of the ORCA

## DISCLAIMER

\*ORCA staff and technicians are not responsible for the installation or maintenance of the facility's plumbing, electrical or IT requirements\*